



# ART. 236530.300

## Manual hose reels - s. 430-530-540-560

Manual trolley-mounted hose reel, s.530, for hot water, 200 bar without hose. Inlet G 3/8" (f), outlet G 1/2" (f). Hose guide, safety system and rotation lock as standard



### FLUIDS

WATER

### SECTORS

AGRICULTURE | LUBE TRUCK AND INDUSTRIAL VEHICLE | BUILDING INDUSTRY AND ROAD CONSTRUCTION | RAILWAY TRANSPORT | MANUFACTURING INDUSTRY | MINING

Features	UM	Value
Pressure	bar	200
Compatible fluids		water max 130 °C
Swivel joint		AISI 304 stainless steel
Seals		Viton®
Characteristic		trolley-mounted
Material		painted steel - zinc plated steel
Couplings		-
Hose		-
Ø and hose length	Ø - m	-
Inlet		G 3/8" (f)
Outlet		G 1/2" (f)
Reel flow path		AISI 304 stainless steel - zinc plated steel
Internal drum width	mm	104

RAASM SpA

via Marangoni 33, 36022 - S. Zeno di Cassola (VI) - ITALIA  
Tel. 0039 0424 571111 - Fax. 0039 0424 571135

info@raasm.com - www.raasm.com

Copyright © 2020 All rights reserved to RAASM S.p.A.



## Overall dimensions

---

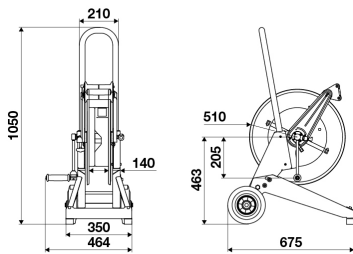

RAASM SpA

via Marangoni 33, 36022 - S. Zeno di Cassola (VI) - ITALIA  
Tel. 0039 0424 571111 - Fax. 0039 0424 571135

info@raasm.com - www.raasm.com

Copyright © 2020 All rights reserved to RAASM S.p.A.