



# ART. 74300.100

Manual hose reels - s. 430-530-540-560

Manual hose reel, s.430, for air-water, 20 bar, without hose. Inlet G 1/2" (f), outlet G 1/2" (f)



## FLUIDS

FRESH OIL | ANTIFREEZE | AIR | WATER | DIESEL FUEL | NITROGEN/INFLATING USE | A1 JET (FUEL FOR PLANES)

## SECTORS

AGRICULTURE | LUBE TRUCK AND INDUSTRIAL VEHICLE | BUILDING INDUSTRY AND ROAD CONSTRUCTION | MANUFACTURING INDUSTRY | MINING | SHIPPING AND OFFSHORE

Features	UM	Value
Pressure	bar	20
Compatible fluids		air - water
Swivel joint		brass
Seals		Viton®
Characteristic		fixed
Material		painted steel
Couplings		-
Hose		-
Ø and hose length	Ø - m	-
Inlet		G 1/2" (f)
Outlet		G 1/2" (f)
Reel flow path		brass - zinc plated steel
Internal drum width	mm	97

RAASM SpA

via Marangoni 33, 36022 - S. Zeno di Cassola (VI) - ITALIA  
Tel. 0039 0424 571111 - Fax. 0039 0424 571135

info@raasm.com - www.raasm.com

Copyright © 2020 All rights reserved to RAASM S.p.A.



Overall dimensions

---

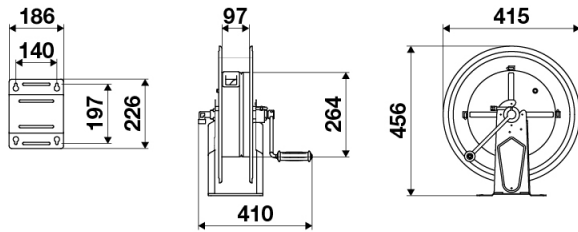

RAASM SpA

via Marangoni 33, 36022 - S. Zeno di Cassola (VI) - ITALIA  
Tel. 0039 0424 571111 - Fax. 0039 0424 571135

info@raasm.com - www.raasm.com

Copyright © 2020 All rights reserved to RAASM S.p.A.